

BARS FROM CELLS TO RECTIFIERS CONNECTION.
SEE DWG. No.: 856-2-36-ZC-0004

CONNECTIONS AT RECTIFIERS OUTPUT
SEE DWG. No.: 856-2-36-ZC-0014

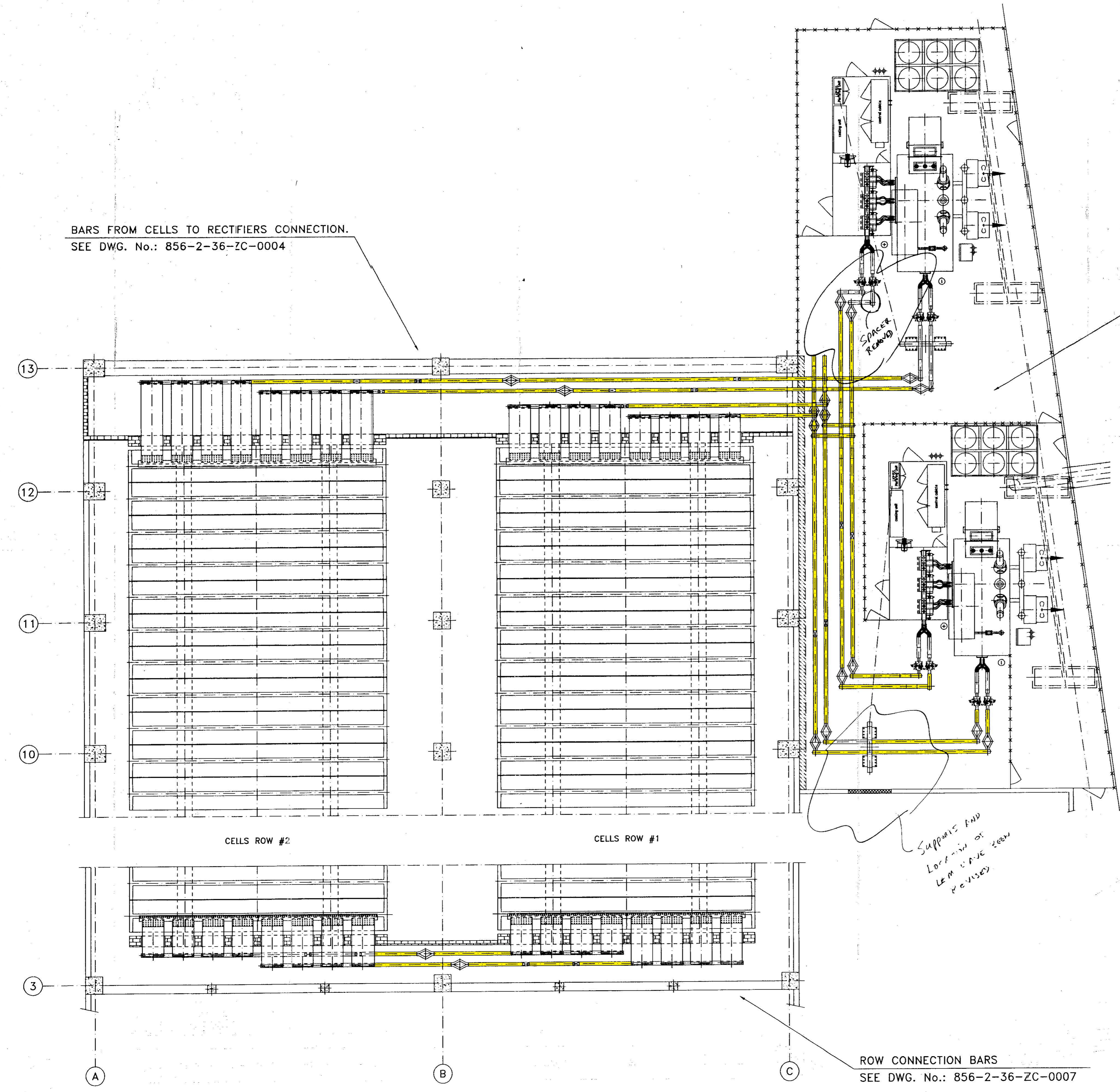

SUPPLIES AND
LOADS IN
LEM CASE 2004
REVISED

ROW CONNECTION BARS
SEE DWG. No.: 856-2-36-ZC-0007

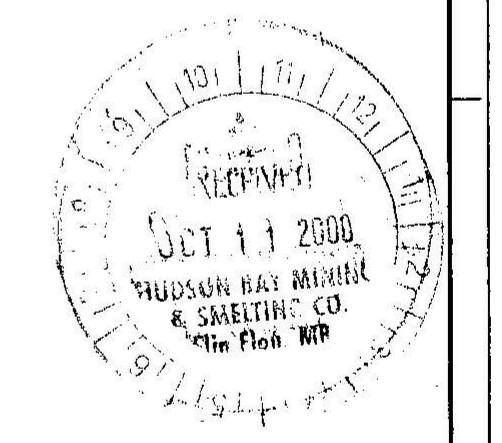

| | |
|------------------------------|---|
| <input type="checkbox"/> TA | Project: "requisit" |
| <input type="checkbox"/> STB | Reviewed: comments as noted; resubmit all revisions |
| <input type="checkbox"/> TC | Reviewed without comments; resubmit all revisions |
| <input type="checkbox"/> TI | For information only |

The review does not release the reviewer of the responsibility for errors in design and assembly as indicated in the contract.

Vendor: Asturiana de Zinc - Main Office No.: ADZ 856-2-36-ZC-0001 Rev: 1 Date Rec'd: [blank]

Description: NEW TANKHOUSE - BUS BARS - BUS BARS GENERAL ARRANGEMENT 01/000

Reviewed by: [Signature] Project: 777 Zinc Plant Expansion

Date: 00/10/02 Purchase Order/Contract: Serial: 013772 - 1-901-00-GE-0261 Submittal: 02

Client Contract No: [blank]
Client Project No: [blank]
Client Drawing No: ZCD 6900 Rev: [blank]

INFORMATION CONTAINED IS CONFIDENTIAL AND PROPRIETARY PROPERTY OF ASTURIANA DE ZINC, S.A.

| Issue | Description | Date | Drawn | Checked | Approved | Client comment or approval | Issue | Description | Date | Drawn | Checked | Approved | Name | Position | Date | Reference Drawings | Drawing number |
|-------|------------------------|----------|--------|---------|----------|----------------------------|-------|-------------|------|-------|---------|----------|------|----------|------|--------------------|----------------|
| 1 | GENERAL REVISION | 28/08/00 | E.M.C. | R.S.L. | Y.L.E. | | | | | | | | | | | | |
| 0 | ISSUED FOR FABRICATION | 11/07/00 | E.M.C. | R.S.L. | Y.L.E. | | | | | | | | | | | | |
| A | INTERNAL ISSUE | 14/06/00 | E.M.C. | AdZT | | | | | | | | | | | | | |

This drawing is and remains the sole property of ASTURIANA DE ZINC, S.A. División Tecnología and must not be used for any purpose whatsoever other than the single purpose for which it has been supplied. It must be returned to the PROPRIETOR at his request together with any copies that have been made.

ASTURIANA DE ZINC, S.A.
División Tecnología

HBM&S 777 ZINC PLANT EXPANSION
NEW TANKHOUSE - BUS BARS
BUS BARS GENERAL ARRANGEMENT

Scale: 1:100
Size: A1
Project No: 82856
Drawing number: 856-2-36-ZC-0001
Rev: 1